

MIPROMET



Clamps

for drums

miproClamp

Table of Contents

Table of Contents	2	GB-O Drum turning clamp	6
Description of abbreviations, acronyms and designations	2	GB-OP Drum clamp	7
GB Drum clamp	3	GB-P Drum clamp	7
GB-B Drum clamp	3	GB-S Drum clamp	8
GB-D Drum clamp	4	GB-T Drum clamp	8
GB-DK Drum clamp	4	GB-U Drum clamp	9
GB-HF Drum clamp	5	GB-W Drum clamp	9
GB-L Drum clamp in a horizontal position	5	Dimensions of steel drums in accordance with the ISO standard	10
GB-N Drum turning clamp	6		

Index

GB	3	GB-DK	4	GB-N	6	GB-P	7	GB-U	9		
GB-B	3	GB-HF	5	GB-O	6	GB-S	8	GB-W	9		
GB-D	4	GB-L	5	GB-OP	7	GB-T	8				

Description of abbreviations, acronyms and designations

MBL – Minimum Breaking Load
WLL – Working Load Limit

100% strength test
according to App. to EN 13155

Each product offered has undergone a strength test in accordance with the relevant annex to the harmonised standard PN-EN 13155

2006/42/EC
manufactured according to Directive

The product complies with the Machinery Directive 2006/42/EC, which confirms the performance of tasks leading to the fulfilment of health and safety requirements for machines placed on the market for the first time in the EU.

16 000
max. working cycles

Design operating lifetime of the device assuming nominal operating conditions and nominal load. The given parameter can be used to estimate the technical condition of the device or the degree of its wear.

EN 13155
meets the Standard

The product meets the requirements of the indicated standard.

Working temperature
-20 +100°C
for steel elements

Permissible temperature range for steel elements during operation with nominal load. Products with covers, linings, linings or components made using thermoplastics have a different, usually narrower operating temperature range. Please refer to the product documentation for details.

Working temperature
-20 +60°C
for plastic elements

CE
Declaration of conformity

The product is marked with the CE conformity mark, has an EC declaration of conformity, issued by the manufacturer, confirming on his sole responsibility that the marked product meets the requirements of EU directives.

Made in EU

Marking of the producer location. It confirms that the product was made within EU, from domestic materials, with the help of employees employed in accordance with EU labour law, meeting EU requirements concerning quality, working conditions and professional qualifications. The responsibility for the product lies with the EU legal entity.

24h
INSTOCK Program

Product covered by the Instock Program. Orders placed for this product, correctly placed by 11:00 a.m. are sent to the recipient on the same day. For products requiring individual marking or unusual packaging, the shipping time may be extended to 2 working days. The quantity of products ordered in the Rapid Dispatch mode is limited to the size of the stock. Detailed requirements of the Programme are described in the Rules and Regulations of the Rapid Dispatch Programme, available on the www.mipromet.eu website.

Mipromet Sp. z o.o. reserves the right to possible modifications and changes in the construction, materials and specifications of individual products. We have made every effort to ensure that the information presented is reliable and helpful, however, we are not responsible for the effects of actions taken on the basis of these contents. This material does not constitute an offer within the meaning of the Civil Code and is for informational or educational purposes only. The information provided in this publication is intended to help the reader to gain an overall understanding of the technical aspects of our offer and to select the best solutions. All products described in the catalogue have appropriate approvals, instructions and certificates.

The entire publication is the property of Mipromet Sp. z o.o. and is a work within the meaning of the Act of 4 February 1994 on Copyright and Related Rights (Journal of Laws No 90, item 631). No part of it may be distributed or copied in any way (electronic, mechanical or other) without written consent of Mipromet Sp. z o.o.

GB Drum clamp



2006/42/EC
manufactured according to Directive

EN 13155
meets the Standard

-20 +100°C
working temperature

16 000
max. working cycles

strength test
100% according to PN-EN 13155

Made in EU



- self-locking handle (the gripping force is proportional to the force of gravity) - the minimum weight of the lifted load cannot be less than **10% of WLL**

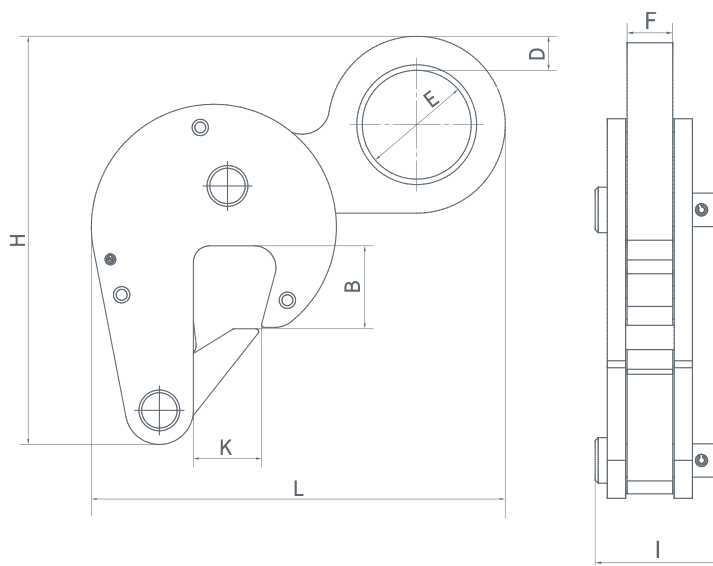
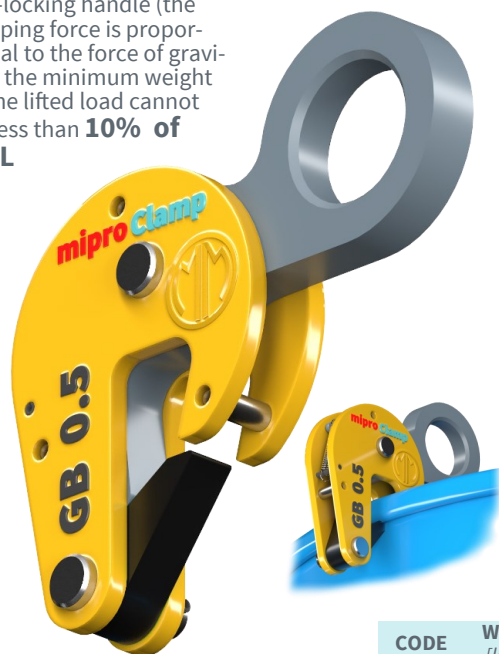

CODE	WLL [kg]	Gripping range [mm]	Dimensions [mm]								Mass [kg]
GB 0.5	500	0 - 24	H	L	K	B	D	ØE	I	F	1,38

GB-B Drum clamp with lining



2006/42/EC
manufactured according to Directive

EN 13155
meets the Standard

-20 +60°C
working temperature

16 000
max. working cycles

strength test
100% according to PN-EN 13155

Made in EU

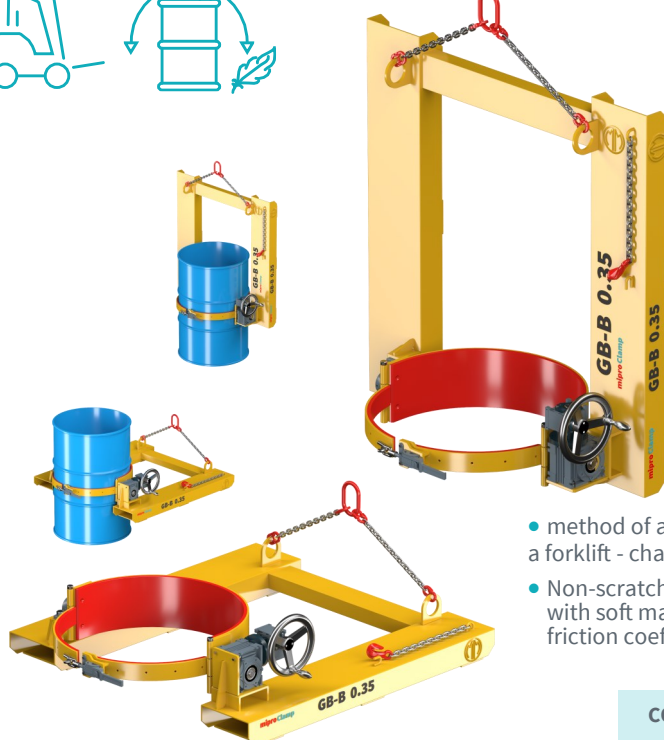

- method of attachment to a forklift - chain sling
- Non-scratching clamp lined with soft material of high friction coefficient

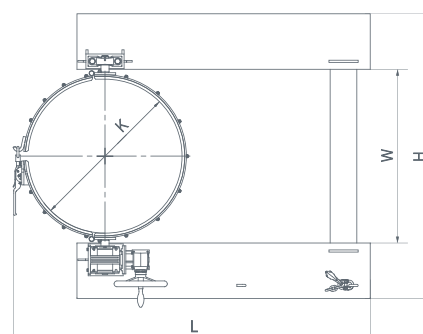
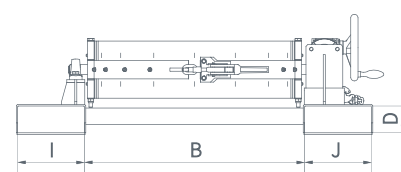

CODE	WLL [kg]	K	L	H	W	B	D	I	J	Mass [kg]
GB-B 0.2	200	310	1 330	958	542	550	80	200	200	67
GB-B 0.35	350	585	1 337	1 068	652	660	90	200	200	71

GB-D Drum clamp



Declaration of conformity
 2006/42/EC manufactured according to Directive
 EN 13155 meets the Standard
 -20 +100°C working temperature
 16 000 strength test max. working cycles 100% according to PN-EN 13155
 Made in EU

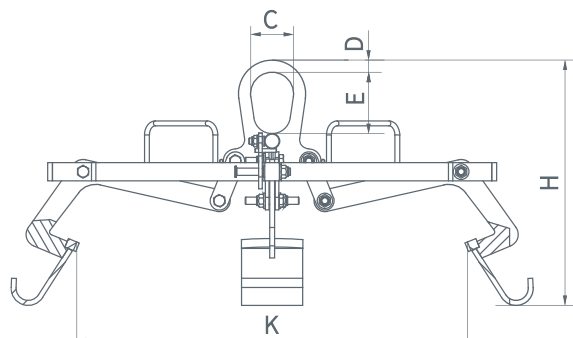

- equipped with a lever that opens / closes the handle (with a safety hook)
- barrel holder with a diameter of Ø581 mm

CODE	WLL [kg]	Gripping range K [mm]	Dimensions [mm]				Mass [kg]
GB-D 0.36	360	471 - 646	H	C	D	E	20

GB-DK Drum clamp



Declaration of conformity
 2006/42/EC manufactured according to Directive
 EN 13155 meets the Standard
 -20 +100°C working temperature
 16 000 strength test max. working cycles 100% according to PN-EN 13155
 Made in EU

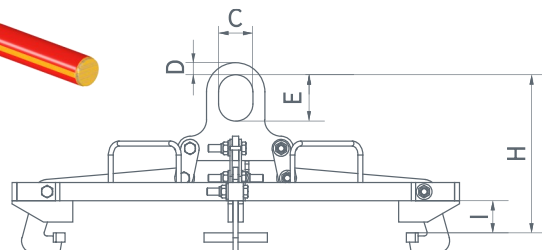
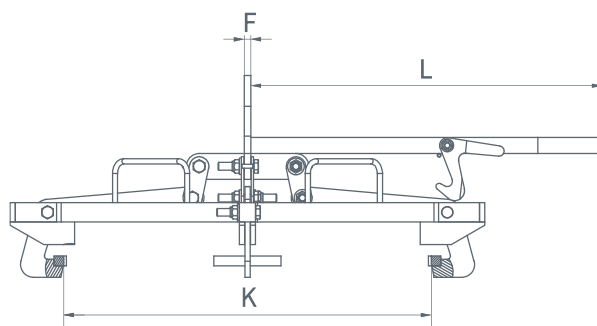

- equipped with a lever that opens / closes the handle (with a safety hook)

CODE	WLL [kg]	Gripping range W [mm]	H	L	F	C	D	E	I	Mass [kg]
GB-DK 0.36	360	570 - 598	260	545	10	56	20	76	53	14

GB-HF Drum clamp

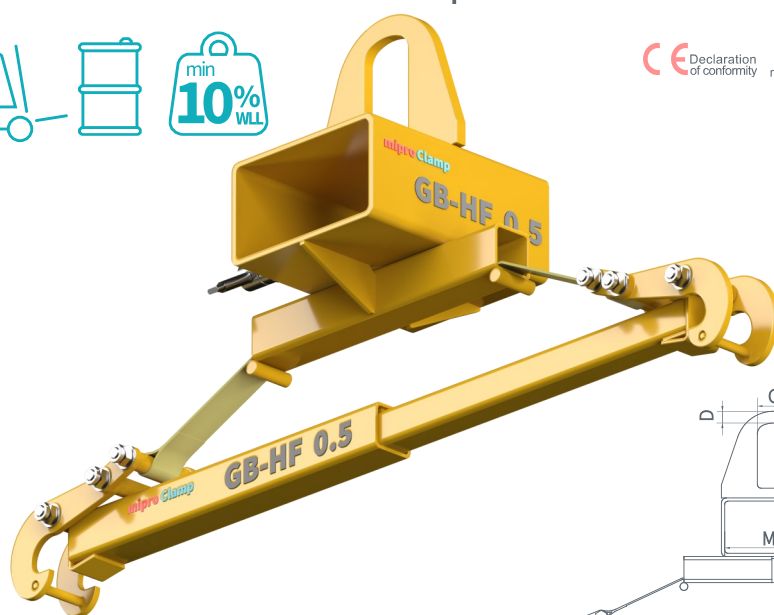

Declaration of conformity
 2006/42/EC manufactured according to Directive
 EN 13155 meets the Standard
 -20 +100°C working temperature
 16 000 max. working cycles
 100% strength test according to PN-EN 13155
 Made in EU

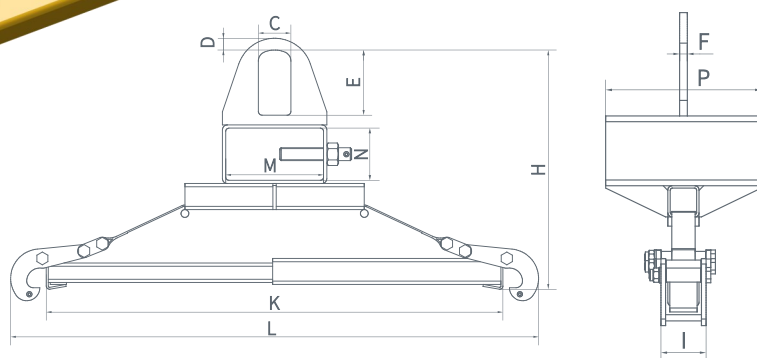

CODE	WLL [kg]	Gripping range K [mm]	Dimensions [mm]										Mass [kg]
GB-HF 0.5	500	420 - 700	L	H	M	N	C	D	E	F	P	I	10

GB-L Drum clamp in a horizontal position



Declaration of conformity
 2006/42/EC manufactured according to Directive
 EN 13155 meets the Standard
 -20 +100°C working temperature
 16 000 max. working cycles
 100% strength test according to PN-EN 13155
 Made in EU

- handles intended for drums with rims
- the maximum angle of opening of the tendons 120°
- the maximum length of the drum is 1000 mm

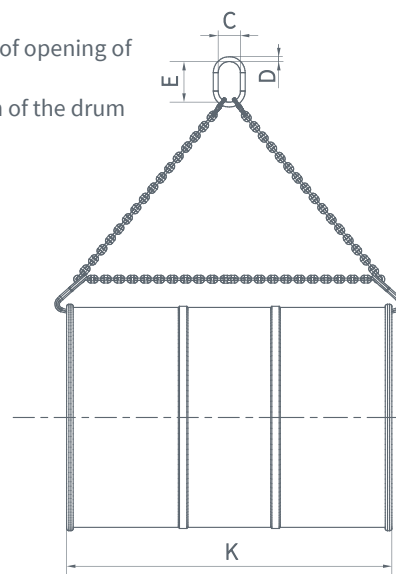

CODE	WLL [kg]	Gripping range K [mm]	Dimensions [mm]			Mass [kg]
GB-L 1.0	1 000	800 - 1000	C	D	E	5

GB-N Drum clamp with lining



- Non-scratching clamp lined with soft material of high friction coefficient

- the handle has rotary locks for both pressure arms

CE Declaration of conformity

2006/42/EC manufactured according to Directive

EN 13155 meets the Standard

-20 +60°C working temperature

16 000 max. working cycles

strength test 100% according to PN-EN 13155

Made in EU

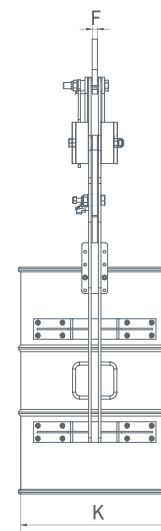
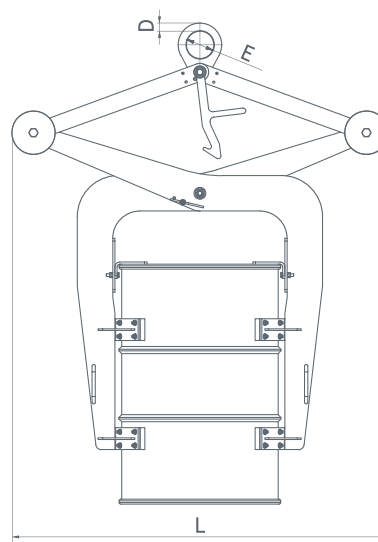

CODE	WLL [kg]	Gripping range K [mm]	Dimensions [mm]				Mass [kg]
GB-N 0.8	800	574	L	F	D	ØE	142

GB-O Drum turning clamp with lining



- Non-scratching clamp lined with soft material of high friction coefficient

- the handle has rotary locks for both pressure arms
- locks can be secured in the open position

CE Declaration of conformity

2006/42/EC manufactured according to Directive

EN 13155 meets the Standard

-20 +100°C working temperature

16 000 max. working cycles

strength test 100% according to PN-EN 13155

Made in EU



INSTOCK program

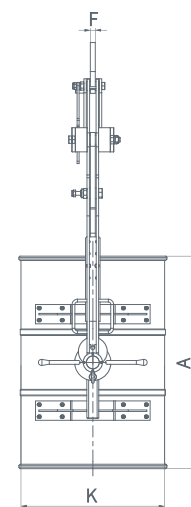
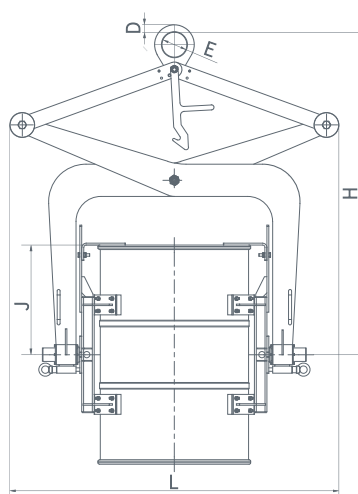

CODE	WLL [kg]	Gripping range K [mm]	Dimensions [mm]							Mass [kg]
GB-O 0.5	500	595 - 600	L	H	J	A	D	ØE	F	125

GB-OP Drum clamp with lining



min
10% WLL

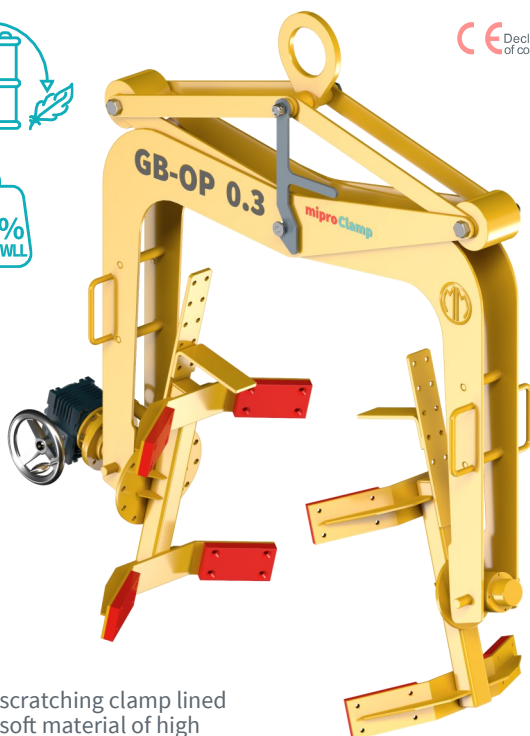

- Non-scratching clamp lined with soft material of high friction coefficient

CE Declaration of conformity

2006/42/EC manufactured according to Directive

EN 13155 meets the Standard

-20 +100°C working temperature

16 000 max. working cycles

strength test 100% according to PN-EN 13155

Made in EU

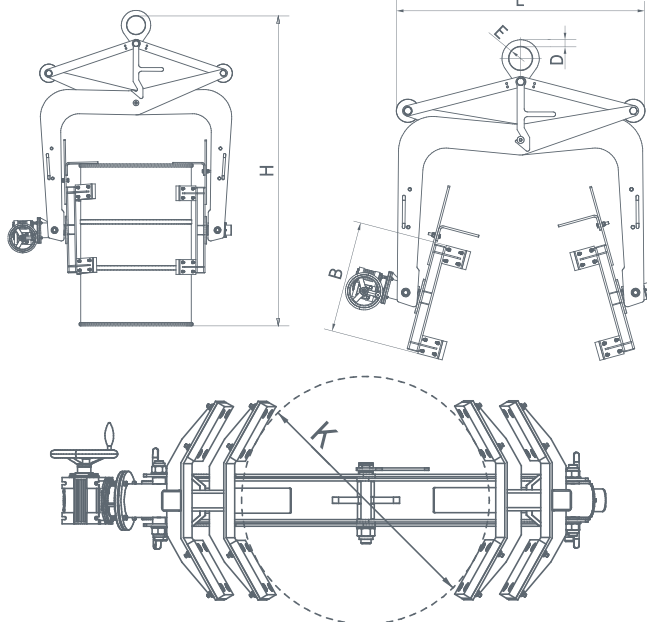

CODE	WLL [kg]	Gripping range [mm]	Dimensions [mm]							Mass [kg]
			K	H	L	B	D	ØE		
GB-OP 0.3	300	400 - 600	590	1 643	1 065	480	30	100		90

GB-P Drum clamp with lining



min
10% WLL



- Non-scratching clamp lined with soft material of high friction coefficient

CE Declaration of conformity

2006/42/EC manufactured according to Directive

EN 13155 meets the Standard

-20 +100°C working temperature

16 000 max. working cycles

strength test 100% according to PN-EN 13155

Made in EU

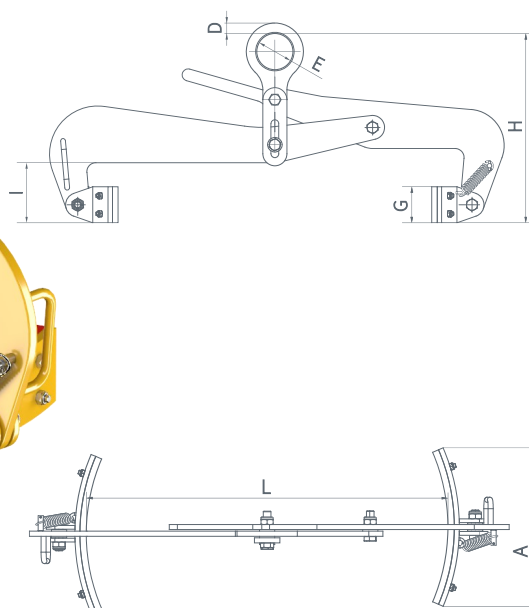

CODE	WLL [kg]	Gripping range L [mm]	H	A	D	ØE	G	F	Mass [kg]
GB-P 0.5	500	570	315	250	17,5	60	60	8	9

GB-S Drum clamp



Declaration of conformity
 2006/42/EC manufactured according to Directive
 EN 13155 meets the Standard
 -20 +100°C working temperature
 16 000 max. working cycles
 strength test 100% according to PN-EN 13155
 Made in EU

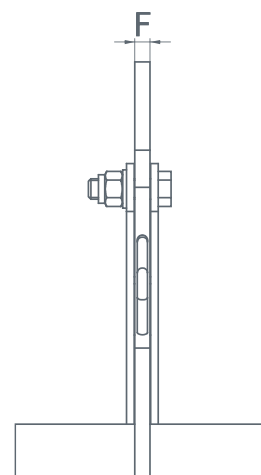

CODE	WLL [kg]	Gripping range K [mm]	Dimensions [mm]				Mass [kg]
			H	D	ØE	F	
GB-S 0.5	500	400 - 610	315	20	60	12	7

GB-T Drum clamp



Declaration of conformity
 2006/42/EC manufactured according to Directive
 EN 13155 meets the Standard
 -20 +100°C working temperature
 16 000 max. working cycles
 strength test 100% according to PN-EN 13155
 Made in EU

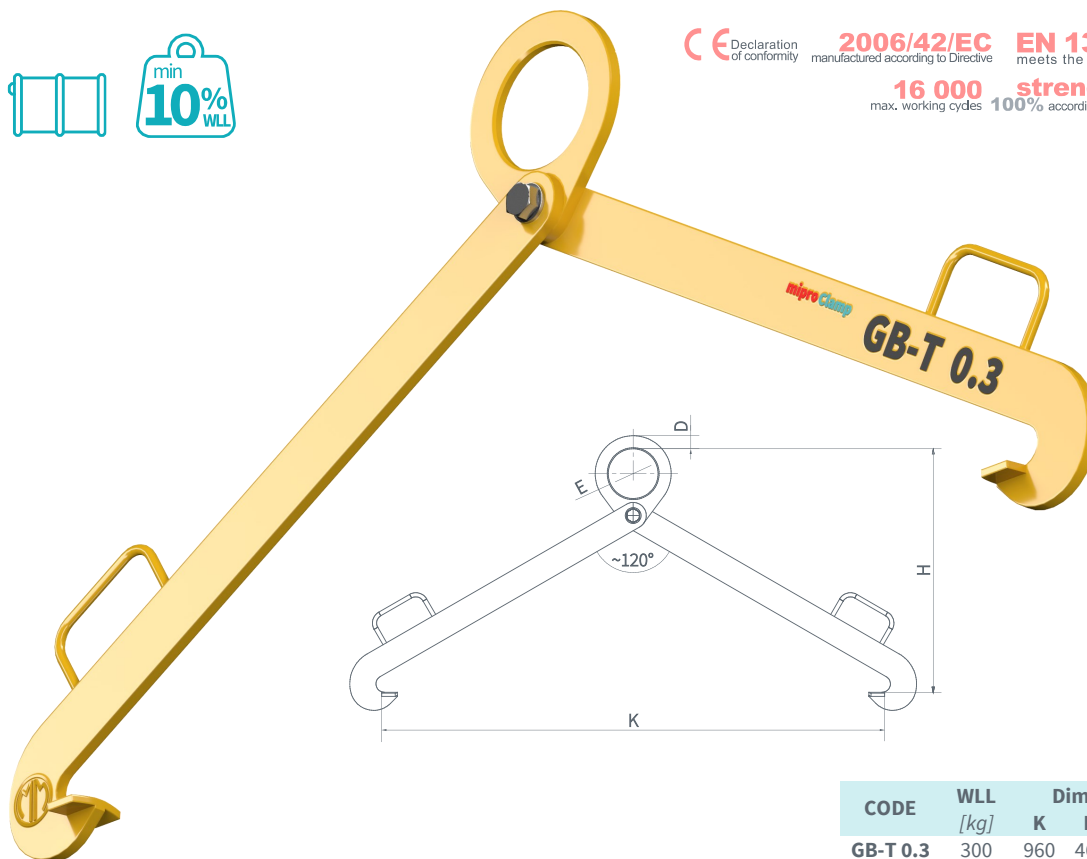

CODE	WLL [kg]	Dimensions [mm]					Mass [kg]
		K	H	D	ØE	F	
GB-T 0.3	300	960	465	25	95	10	7

GB-U Drum clamp

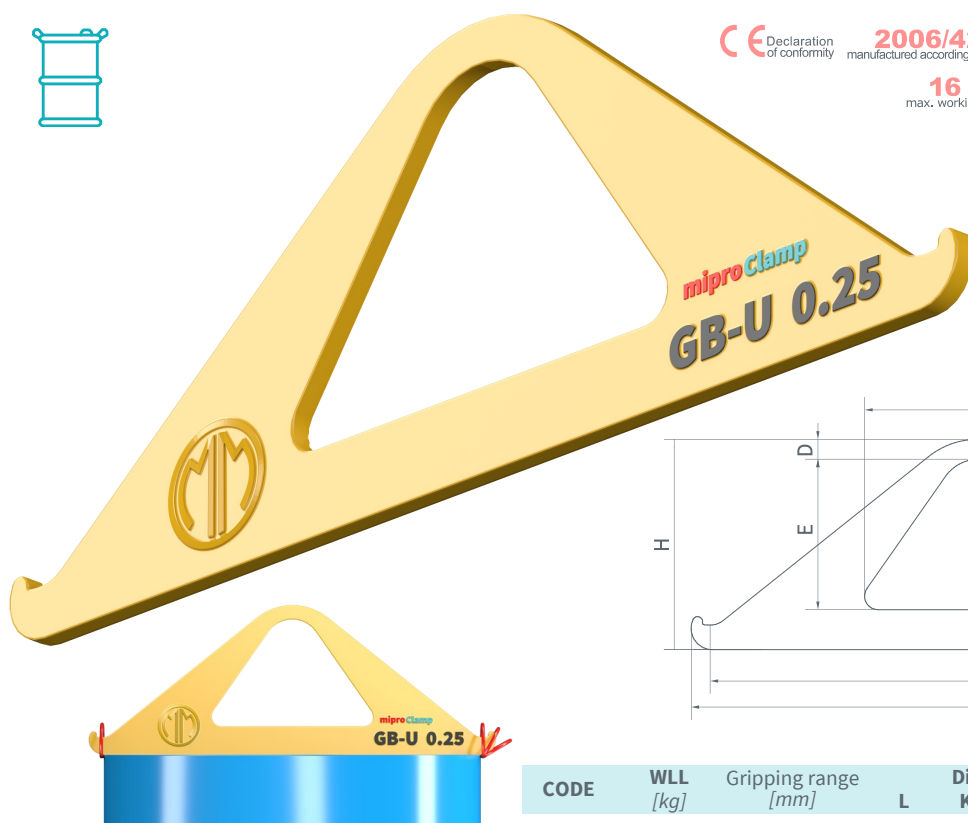

Declaration of conformity
 2006/42/EC manufactured according to Directive
 EN 13155 meets the Standard
 -20 +100°C working temperature
 16 000 max. working cycles
 100% strength test according to PN-EN 13155
 Made in EU

• For drum with lifting eyes

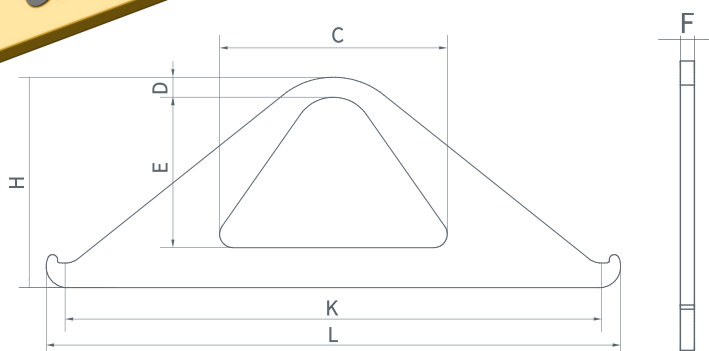

CODE	WLL [kg]	Gripping range [mm]	Dimensions [mm]							Mass [kg]
			L	K	H	C	D	E	F	
GB-U 0.25	250	530	573	535	210	227	20	150	10	3,6

GB-W Drum clamp

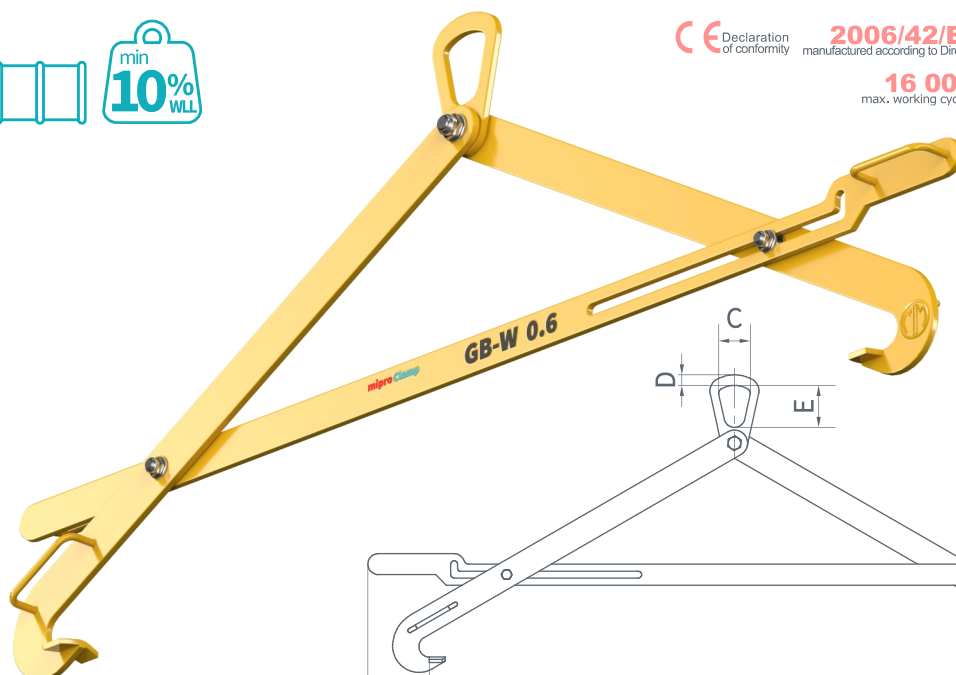

Declaration of conformity
 2006/42/EC manufactured according to Directive
 EN 13155 meets the Standard
 -20 +100°C working temperature
 16 000 max. working cycles
 100% strength test according to PN-EN 13155
 Made in EU

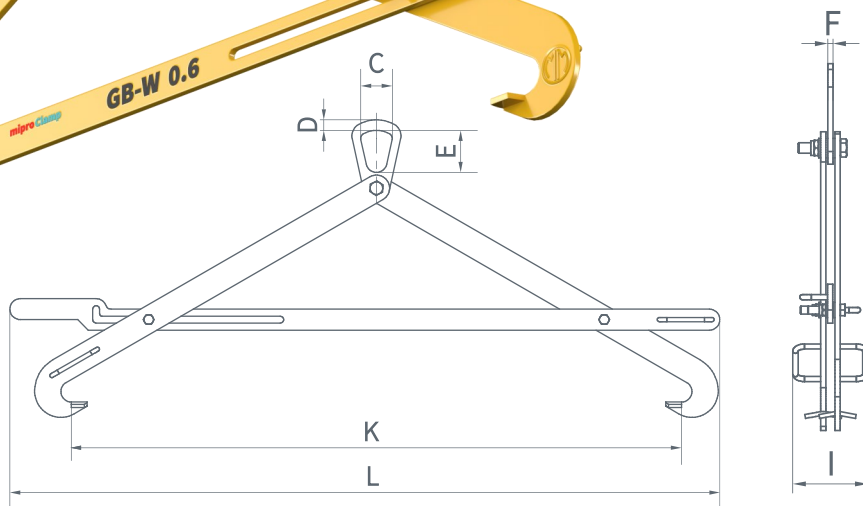

CODE	WLL [kg]	Gripping range K [mm]	Dimensions [mm]							Mass [kg]
			L	C	D	E	I	F		
GB-W 0.6	600	850 - 1 100	1 350	60	20	80	116	8	10	

Addition

Dimensions of steel drums in accordance with the standard ISO 15750-1:2002(E) and ISO 15750-2:2002(E)

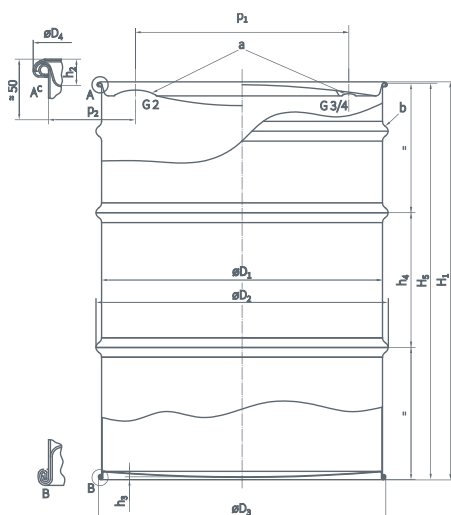

- a Drum cover (optional).
b The third crease on the barrel is optional.
c Details of the B + D drum.

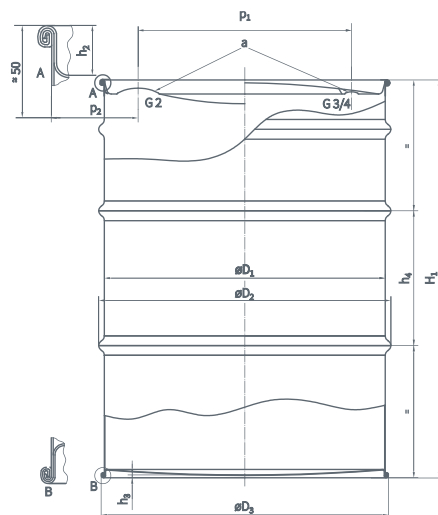

- a The complete closure (stopper and caps / seals) must not protrude above the top of the seam.

Drum without cover							Drum with cover				
	Type A		Type B		Type C	Type D	Type A		Type B		Type C
Capacity	210 l	216,5 l	210 l	216,5 l	208 l	208 l	216,5 l	230 l	216,5 l	230 l	212 l
D ₁	571,5	571,5	571,5	571,5	566	566	571,5	571,5	571,5	571,5	566
D ₂	585	585	596	596	585	585	585	585	596	596	585
D ₃	585	585	593	593	585	585	585	585	593	593	585
D ₄	585	585	610	610	585	620	-	-	-	-	-
H ₁	878	888	878	888	890	890	878	932	878	932	890
H ₅	868	878	868	878	880	880	-	-	-	-	-
h ₂	b	b	b	b	b	b	a	a	a	a	a
h ₃	4	4	4	4	4	4	4	4	4	4	4
h ₄	280	280	280	280	300	300	280	280	280	280	300
p ₁	c	c	c	c	c	c	b	b	b	b	b
p ₂	72	72	72	72	94	94	72	72	72	72	94